

Reno, Sparks & Carson Valley *Relocation* Guide

Everything you need to know about moving to Reno, Sparks & Carson Valley

REAL ESTATE • THE LEADER IN LUXURY
\$2.6
Billion



CHASE
INTERNATIONAL
REAL ESTATE



Contents

General Information

Home Means Nevada	4
Area Profile	5
Downtown Reno Districts	6
Sparks Spotlight	7
Why Nevada?	8
Reno/Sparks Economy	9
Tesla	10
Nevada Economic Growth	12
University of Nevada, Reno	14
Education/School Report/School Map/FAQ's	16
Demographics	22

Services

Residential Utilities & Services/Medical Facilities	24
Childcare & Youth Services	26
Senior Resources	27
Pet & Animal Services	28
Local Churches & Places of Worship/Transportation	29

Things To Do

Special Events/Golf Courses	32
Winter Recreation Parks & Recreation	34
State Parks	36
Places to Eat	37
Shopping	38
Fun Stuff For Kids	39



Home Means Nevada

Entered the Union: October 31, 1864 (34th)

Capital: Carson City

Origin of Name: Spanish for “snow-covered”

State Motto: All for our Country

State Nicknames: Sagebrush, Silver State, Battle Born State

State Song: “Home Means Nevada”

National Forests: 2

State Parks: 24

Famous For: Gambling, Lake Tahoe, Reno, Las Vegas, Gold & Silver
Mining, Wild Mustangs, Outdoor Recreation

- Nevada was made famous by the 1859 discovery of the Comstock Lode, the richest known U.S. silver deposit.
- Nevada is the largest gold-producing state in the nation. It is second in the world behind South Africa.
- Nevada is the gambling and entertainment capital of the United States.
- Las Vegas has more hotel rooms than any other place on earth.
- Most of the state is desert but the Sierra Nevada mountain range near Reno and the Ruby Mountains near Elko have snow for half the year.
- Nevada has more mountain ranges than any other state, with its highest point at the 13,145 foot top of Boundary Peak near the west-central border.
- About 150 couples get married in Las Vegas each day.
- In 1899 Charles Fey invented a slot machine named the Liberty Bell. In 1999 Nevada had 205,726 slot machines, one for every 10 residents.



Area Profile

Located in the majestic Sierra Nevada Mountains, the breathtaking Reno-Sparks-Lake Tahoe area is not your average vacation destination. From the arts to the cultural splendor, from the casinos to its unprecedented natural surroundings, Reno is a city rich in both tradition and fresh entertainment.

Minutes from world-famous Lake Tahoe, the Reno-Sparks community is surrounded by natural beauty and limitless recreational opportunities. The Reno-Sparks-Lake Tahoe region has over 18 world-class ski resorts, many just a short 45-minutes from downtown, and 40-plus golf courses. The area also boasts 60 gaming locations, the National Bowling Stadium, the National Automobile Museum, Rancho San Rafael Park’s Arboretum and Wilbur D. May Great Basin Adventure, the historic boomtown of Virginia City, and world-class fishing, hiking, biking and numerous other outdoor activities. The quality of life in the region is tough to beat.

At 4500 feet altitude, the Reno area offers four distinct seasons with few extremes. Average temperatures range from winter lows in the 20’s to summer highs in the 90’s. Low humidity characterizes the area, making the cool days seem not so cold and the warm days not so hot. Rain is scarce, snow is certain. Here the sun shines more than 300 days a year.

Tax benefits (no corporate, personal income, unitary, inventory, or franchise tax), accessibility to western markets, transportation hub, abundance of available industrial/office/commercial space, advanced telecommunications infrastructure, business-friendly regulations, and high quality of life make Reno/Sparks/Lake Tahoe an extremely attractive place to do business and live.

Northern Nevada Climate		
Temperature	High	Low
Annual	67.4	35.2
January	45.5	21.8
April	64.1	33.2
July	91.2	51.4
October	69.9	34

Distances to other Western Cities		
City	Miles	Airtime
Las Vegas	441	1:00
Los Angeles	475	1:06
Phoenix	753	2:00
Portland	586	1:30
Sacramento	135	0:25
Salt Lake City	526	1:00
San Francisco	231	0:50



Downtown Reno Districts

There is a renaissance in Downtown Reno! The swelling tide of enthusiasm, energy and investment has created an environment for adaptive reuse of property, new businesses, historical preservation and improved residential areas and arts and cultural activities. Downtown Reno as a whole and its unique connected districts have been features in AAA, Via, New York Magazine and Sunset Magazine - *Northern Nevada Business Weekly*.

Highlights

- Whitewater Park
- Masonic, Bruka & Lear Theatre
- Hub for ARTown Festival
- National Bowling Stadium
- Old Lincoln Highway
- Reno Bike Project
- Start-Up Row
- National Automobile Museum
- Reno Aces Ballpark
- Nevada Museum of Art
- Discovery Museum
- Unique locally owned businesses
- Multicultural Businesses
- Midtown
- The Arch District
- University District
- Liberty District
- Wells District
- Old Brewery District





Sparks Spotlight

Since the 1990's Sparks has grown tremendously, offering residents and visitors a wide array of services and activities. Sparks was reported as the fastest growing city in Nevada between 1999 - 2008 and continues to grow. Quality of life is cited as one of the main reasons people relocate to the Sparks area. Summer and winter outdoor activities abound!

Sparks is known as the premiere special events venue for all of northern Nevada with attractions on the Victorian Square bringing thousands of visitors to such annual events as Hometown Farmer's Market, Hot August Nights, Best in the West (Nugget) Rib Cook-off and Hometowne Christmas.

Highlights

- Victorian Square
- Sparks Marina
- Legends Shopping Center
- Scheels
- Golden Eagle Sports Complex



Why Nevada?

Current Population Washoe County:

460,587

Reno Business and Gaming

When people think of Reno, they think of gambling. However, over the last couple of decades, Reno and Sparks have become much more than just gaming cities. With many prominent corporations residing in the area, INC Magazine rated Reno as the sixth best spot to do business for a mid-sized city.

Nevada Tax Structure

Nevada's tax structure continues to be one of the least burdensome in the country, allowing both business and employees to flourish.

Nevada has NO:

- Corporate Income Tax
- Unitary Tax
- Inventory Tax
- Estate and/or Gift Tax
- Personal Income Tax
- Franchise Tax
- Inheritance Tax
- Special Intangible Tax

Additional Advantages of Doing Business in Nevada:

- Stockholders, directors and officers need not live or hold meetings in Nevada
- Directors need not be stockholders
- Officers and directors of a Nevada Corporation can be protected from personal liability for lawful acts of the corporation
- Nevada corporation may purchase, hold, sell or transfer shares of its own stock

Cost of Living		
Area	Avg. Home Price	Avg. Apartment Rent
Reno	\$497,500	\$1,386/mo
Sparks	\$429,670	\$1,640/mo
Carson Valley	\$424,000	\$1,180/mo

US Best States for Doing Business:

State of Nevada ranked #9 Chief Executives' annual survey asked over 600 CEOs to grade each state on the following criteria:

- Taxation & Regulation
- Workforce Quality
- Living Environment

Regions largest non-gaming employers:

1. Washoe County School District
2. University of Nevada, Reno
3. Washoe County
4. Renown Medical
5. International Game Technology

Reno-Sparks Largest Industry Sectors:

1. Wholesale Trade, transportation & Utilities
2. Leisure & Hospitality
3. Accommodation and Food Service
4. Government
5. Professional & Business Services
6. Educational and Health Services
7. Retail Trade
8. Goods Producing
9. Local Government
10. Casino Hotels

Sales Tax Rate	
Carson County	7.6
Churchill County	7.6
Clark County	8.25
Douglas County	7.1
Lyon County	7.1
Storey County	7.6
Washoe County	8.265

Reno/Sparks Economy

Reno's economy is principally based in the trade and service sector, with approximately 65% of the work force employed in these occupations. Although gaming and other recreational activities represent a significant portion of the growing economy and assessed valuation, the City is experiencing a gradual diversification of its business base with the expansion of distribution, warehousing, and manufacturing facilities. Approximately 25% of the workforce is employed in the fields of construction, manufacturing, transportation, communications, public utilities, and finance related services.

The Reno area is serviced by two major highways. Union Pacific railroad and a number of trucking and airline carriers make it possible to ship Reno to 80% of the 11 western states on a next-day basis.

Nevada has no corporate or personal income tax, and is a right-to-work state. These factors have contributed to the State's tremendous growth in the 1990's and into the 2000's. In 2005, Inc. Magazine named Reno No1 on its list of the "Best Places to Do Business in America," based on job growth figures among 274 metropolitan areas.

In addition to the accomplishments of the Economic Development Authority of Western Nevada in bringing new business to Northern Nevada, the City of Reno Economic and Redevelopment Agency has begun both entertainment and housing projects in the City's downtown sector.

Over thirty million dollars of City and one billion dollars in private/other public investment has been made in downtown Reno to modernize and beautify infrastructure and facilities. A maintenance district was established to ensure that the downtown area will remain clean and beautiful. The City also established a police district downtown to ensure a safer environment.

Source: City of Reno - <http://www.reno.gov/business/reno-s-economy>

City of Reno	www.reno.gov	775.334.4636
City of Sparks	www.cityofsparks.us	775.353.5555
Washoe County	www.washoecounty.us	775.328.2000
State of Nevada	http://nv.gov	Various listings
Nevada Department of Taxation	http://tax.nv.gov	1.866.962.3707
Nevada Secretary of State	www.nvsos.gov	775.684.5708
Nevada Association of Employers	www.nae-online.org	775.329.4241
Reno-Sparks Chamber of Commerce	www.thechambernv.org	775.636.9550
Reno-Sparks Convention & Visitor's Authority	www.visitrenotahoe.com	800.367.7366
Economic Development Authority of Western NV	www.EDAWN.org	775.829.3700
Job Opportunities in Nevada	www.join.org	775.785.6106
Center for Regional Studies (UNR)	www.centerforregionalstudies.org	775.784.1771
Small Business Department (UNR)	www.nsbdc.org	800.240.7094

Tahoe Reno Industrial Center

As the Tahoe Reno area continues to expand, more companies continue to move over to the vast open land in our beloved Silver State. Companies such as Tesla, Google, Switch, and Blockchain hope to create the next Silicon Valley and bring thousands of employment opportunities for native residents and all those to come.

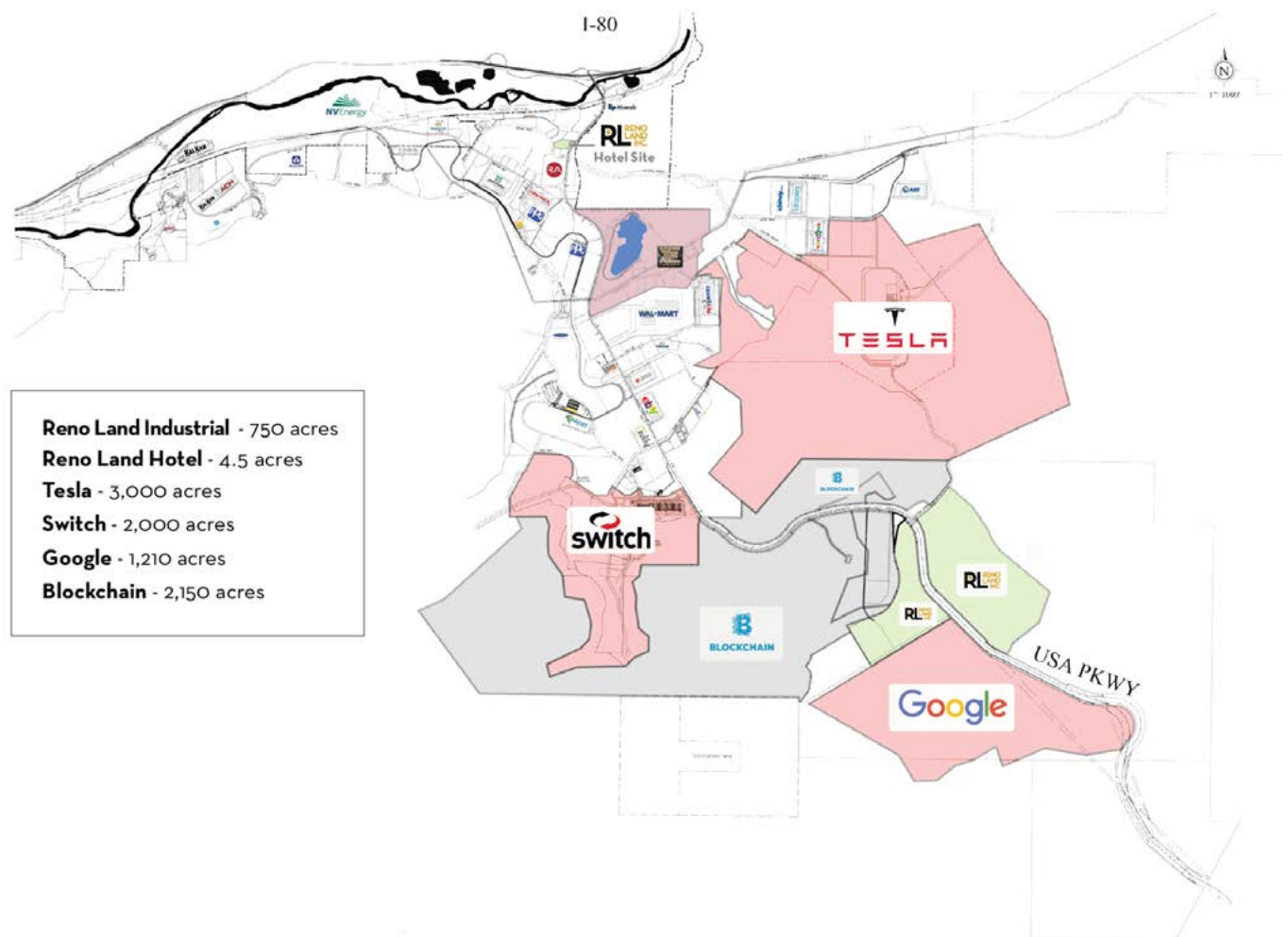



Tesla Battery Gigafactory

California electric car maker Tesla, in partnership with Japan's Panasonic Corp., is building the world's largest lithium ion battery factory at the 165-square-mile Tahoe-Reno Industrial Center 20 miles east of Reno. The industrial center encompasses about 60 percent of Storey County's land mass.

Word that Tesla Motors is taking up residency in Northern Nevada has companies around the world doing a double-take of the Reno-Sparks area and inquiring about what the Silver State has to offer, an economic development official said. "It puts us not only on the national radar for site selectors and companies looking for locations in the West, but we're getting calls from across the globe — Belgium, Germany, China," said Mike Kazmierski, president and chief executive officer of the Economic Development Authority of Western Nevada.

"What is often missed is all the secondary jobs. The companies that need to or want to be in the vicinity of Tesla," Kazmierski said. "And then many other companies that just want to be in the area now that Tesla has identified this region as a great place for advanced manufacturing." "Tesla moving to Nevada will create a domino effect as many more businesses will follow," agreed Robert Hooper, executive director of the Northern Nevada Development Authority.

A look at the \$100 billion estimated economic impact from the Tesla Gigafactory:

- 6,500 direct factory employees earning an average wage above \$25 an hour
- 3,000 construction jobs
- \$1.5 billion indirect tax revenue generated over 20 years
- \$400 million direct tax revenue generated beginning in 2024
- 16,000 indirect jobs once the factory is up and running
- Overall job creation equal to 2 percent of state's workforce and 11 percent of the region's workforce
- A 4 percent increase in the state's GDP is expected and the region's economic output is expected to jump by 20 percent

Source: Governor's Office of Economic Development

Northern Nevada Economic Growth



ECONOMIC DEVELOPMENT AUTHORITY OF WESTERN NEVADA

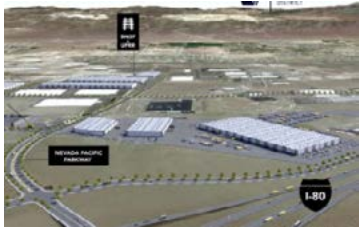

Victory Logistics District Master Planned Industrial Development in Fernley NV

Fernley, NEVADA (July 16, 2019) – Mark IV Capital, a privately held real estate company founded in 1974, announces its acquisition of the Crossroads Commerce Center in Fernley, Nevada with the help of Brett Edwards and Rex Massey of CBRE. The 4,300-acre property has been rebranded to Victory Logistics District. The acquisition was completed in partnership with Heath Rushing of New Nevada Resources, and the project is anticipated to be the region's premier Class-A distribution, manufacturing and commercial center.



Figure Technologies, A Transformative FinTech Company and Blockchain Pioneer, Moves to Reno, Nevada

RENO, Nev. (December 17, 2018) – The Economic Development Authority of Western Nevada (EDAWN) announced today that Figure Technologies, a financial technology company leveraging blockchain, AI and analytics to deliver products to improve the financial lives of their customers, is expanding operations to Reno, Nevada. The new office is already home to 17 full-time employees supporting Figure's business across the US. Key factors in Figure's decision to expand to Reno were the talent pool and logistical advantages offered by the region, along with the opportunity to invest in the region's academic and start up communities. The company plans to hire 240 employees in a wide range of roles over the next several years.



rfxcel A Leader in Track and Trace Technology Moves to Reno, NV. Corporate HQ and Operations to Bring 200 Jobs

RENO, Nev. (November 27, 2018) – The Economic Development Authority of Western Nevada (EDAWN) announced today that rfxcel, the most tenured provider of track and trace solutions in the market today is relocating its corporate headquarters to Reno, Nevada. The new office is expected to open its doors this December 2018. The office will serve as rfxcel's main headquarters as well as its research and development and back-office operations center. The company plans to hire up to 200 employees over the next several years.



RIZKNOWS Digital Media Company Announces New Corporate Headquarters and Operations in Reno. Brings More Tech Jobs

RENO, Nev. (Nov. 8, 2018) – The Economic Development Authority of Western Nevada (EDAWN) announced today that RIZKNOWS, an innovative, digital media company has moved its corporate headquarters and video operations to a newly renovated 6,000 square foot facility in downtown Reno, Nevada. The company has already begun hiring and is expected to fill up to 20 positions. This announcement was made at EDAWN's Major Investor Luncheon held today at the Atlantis Casino Resort.



New Deantronics Building \$40M Tech Campus in Reno-Sparks Area

RENO, Nev. (September 25, 2018) – The Economic Development Authority of Western Nevada (EDAWN) announced today that New Deantronics (ND), an international, medical device technology manufacturer is establishing its U.S. facility in the Spanish Springs Business Center in Washoe County.

Northern Nevada Economic Growth



Monin to Open Manufacturing and Distribution in Washoe County

RENO, Nevada (April 26, 2018) – The Economic Development Authority of Western Nevada (EDAWN) announced today that Monin Inc., a worldwide manufacturer and supplier of gourmet flavorings will be opening a new facility in the Spanish Springs area of Washoe County with plans to add up to thirty quality jobs. The new location and 100,000sf facility is part of a long-term strategic plan to become the backbone of Monin America's west coast operations.



Big Rock Sports Opens New Distribution Facility in Reno

RENO, Nev. (October 26, 2017) – The Economic Development Authority of Western Nevada (EDAWN) announced today that Big Rock Sports, a premier outdoor sporting goods distributor headquartered in Graham, North Carolina, is opening a new distribution facility located on Moya Boulevard in Reno, Nevada. The company is planning to fill up to 50 positions in their first year of operation.



Pricing Technology Company Brings Jobs to Reno, Broker Genius Opens Office Downtown

RENO, Nev. (Oct. 16, 2017) – The Economic Development Authority of Western Nevada (EDAWN) announced today that Broker Genius Inc., a software technology company headquartered in Valley Stream, New York that specializes in automated ticket pricing, opened a West Coast satellite office in Reno, Nevada. The company is looking to hire several talented analysts to staff the new location on S. Virginia Street over the next few months.



Start-Up Tech Company Establishes Headquarters in Reno, NV. Alchemy Plans to Double Workforce Annually

RENO, Nev. (Sept. 18, 2017) – The Economic Development Authority of Western Nevada (EDAWN) announced today that Alchemy, a software services and solutions company, is establishing its headquarters in Reno, NV. Located on Double Eagle Drive in Reno, the company recently began hiring for a variety of full-time and intern positions and is expected to double its workforce annually over the next three years.



Geofortis State-of-the-Art Mineral Processing Facility to Open in Reno

RENO, Nev. (June 16, 2017) – The Economic Development Authority of Western Nevada (EDAWN) announced today that Geofortis Pozzolans is opening a state of the art cementitious material, mineral processing facility in Reno, Nevada. Development of the 30,000 sf facility is expected to commence in August with processing operations to start by April 2018. The company plans to hire more than 200 employees by end of Year 5 and will be investing upwards of \$20 million in capital expenditures. Geofortis also received incentives from the Governor's Office of Economic Development.



Udacity Launches First of Its Kind Learning Program in Reno to Develop Local Tech Talent

RENO, Nev. (May 18, 2017) – Udacity, a leading online education company announced a new local program in Reno today known as Udacity Connect, that will offer both online and in-person courses to teach Reno-Tahoe residents to become full stack web developers — a high-demand job in the region. This program is the first of it's kind and has launched in the Reno community with plans to expand other course offerings in Robotics, Machine Learning, and Self Driving Car Engineering. Udacity is focused on connecting learning to jobs training workforces for today and tomorrow.



University of Nevada, Reno

The University of Nevada, Reno is the state's historic flagship institution of higher education. The University has a student enrollment of more than 16,000, including about 3,200 graduate students, and a total budget of nearly \$500 million.

The University provides a broad range of programs and degree options, ranging from baccalaureate degrees in more than 75 disciplines to more than 100 graduate-degree programs at the master's and doctoral level. The University of Nevada School of Medicine is a vital component of the University, with campuses in both of Nevada's major urban centers, Las Vegas and Reno, and a health network that extends to much of rural Nevada.

The University of Nevada was founded in 1874 in Elko as the state's first institution of higher education. Relocated to Reno in 1887, the University remained the state's only institution of higher education for 75 years. The first building on the Reno campus, Morrill Hall, is still in use today, and the campus has grown from a small cluster of buildings surrounding a central quadrangle (modeled after Thomas Jefferson's design for the University of Virginia), to a 250-acre site just north of downtown Reno. The University is one of eight institutions of higher education governed by the Nevada System of Higher Education.

The University has 76 undergraduate degree programs, and more than 100 graduate degree programs (66 master's and 37 doctoral programs) from which students may choose. New majors approved recently include Atmospheric

Sciences, Environmental Science, Forest and Rangeland Management, Wildlife Ecology, and Computer and Information Engineering. The University is also in the process of adding new Ph.D. programs in Mathematics, Statistics, and Geography, and a new interdisciplinary undergraduate program in Environmental Studies. The tuition for Nevada resident undergraduates is among the lowest in the western United States and is a reflection of the Board of Regents' and state legislature's policy to provide access to as many Nevada high school graduates as are qualified. For example, the resident undergraduate tuition and fees total \$2,850, which is lower than all but one of 15 western states. Non-resident undergraduate tuition and fees total \$11,524 which is at the median for the western states.

Coupled with its status as a land-grant institution, the University necessarily has a statewide mission and boasts programs and activities in all 17 counties of the state. It has more than 700 employees outside the Reno area, most of them in Las Vegas. It plays a critical role in the promotion of health throughout the state through its Schools of Medicine, Nursing, and Public Health.

The University's athletics programs compete in NCAA Division I as part of the Western Athletic Conference (WAC). The University fields competitive teams in 18 sports, with seven men's sports and 11 women's sports teams offering scholarships.

A Top Tier University



The University of Nevada, Reno was ranked by *U.S. News & World Report* magazine in the top tier of national universities in its 2018 "Best Colleges" issue.

\$800,000,000

in new state-of-the-art facilities added since 2007.

1,274

instructional faculty serve our campus, guiding, instructing and mentoring our students.

\$2.9 Million

student budget which supports campus clubs and organizations at the University.

90%

of graduating students are employed or in graduate school within one year of graduating.

1st

in the nation for online MBA program 3-year graduation rate according to *U.S. News & World Report*.

144



years and counting as the state's Land-Grant university, providing access to higher education to all Nevadans. We continue this tradition by serving citizens in every county of the Silver State.

44%

of incoming 2017 freshmen were from culturally diverse backgrounds.

400+

National Merit and Presidential Scholars on campus.



National Geographic named Reno as a top ski town in the nation.

10 emerging

The University ranks in the top **20%** nationwide in the 2017 *Payscale Return On Investment Report*.

Education

How to Register

Any student NEW to the Washoe County School District (WCSD) must present a birth certificate or passport and an immunization record from your health care provider. A utility bill may be necessary for proof of residency, and the student's Social Security number also is requested. High school students younger than 18 need to be accompanied by a parent or legal guardian in order to register. If you are not sure which school your child should attend, call the Zoning Office at 348.0200 or visit <http://buses.washoeschools.net>.

Immunizations

For information on Immunization clinics call 328-3724. Immunizations are required for children attending Washoe County schools. Make sure your child's immunizations are up to date. Bring your child's shot record.

The following clinics offer immunizations:

- Washoe County Health Department - 775.328.3724
- Health Access Washoe County - 775.329.6300

Washoe County School District - www.washoeschools.net - 775.348.0200

The Washoe County public schools offer a superior education to 55,000 students in over 83 schools. The students mirror the excellent programs and curriculum offered by consistently scoring above state and national norms in standardized achievements tests as well as college entrance exams.

The District offers a full spectrum of curricular offerings from special education to gifted and talented at all schools. It offers special programs in alternative education for at-risk students, drug education and for all students an aggressive program in sex and AIDS education. Offerings in forensics, music and art help prepare students for future life. The high schools offer over 60 extracurricular activities for both girls and boys.

Private Schools

Bishop Manogue Catholic

High School
110 Bishop Manogue Drive
775.336.6000
www.bishopmanogue.com

Brookfield School

6800 S. McCarran Blvd
775.825.0257
www.brookfieldschool.com

Excel Christian School

850 Baring Blvd
775.356.9995
www.excelchristianschool.com

Lake Tahoe School

995 Tahoe Blvd, Incline Village
775.831.5828
www.laketahoeschool.org

Little Flower Elementary

1300 Casazza Drive
775.323.2931
www.littleflowerschoolnv.org

Mountain View Montessori

565 Zolezzi Lane
775.852.6162
www.mountainviewmontessori.com

Sage Ridge School

2515 Crossbow Court
775.852.6222
www.sageridge.org

Truckee Meadows Christian

Academy
3940 Spring Drive
775.823.9002

www.privateschoolreview.com for a complete list of private schools in Washoe County

Education

Other Universities and Colleges

Career College of Northern Nevada

1421 Pullman Drive
775.856.2266
www.ccn.edu

Desert Research Institute

2215 Raggio Parkway
775.673.7300
www.DRI.edu

Academy of Arts, Careers & Technology

380 Edison Way
775.861.4418
www.washoeschools.net/aact

Sierra Nevada College

999 Tahoe Boulevard
775.831.1314
www.sierranevada.edu

Truckee Meadows Community College

7000 Dandini Blvd
775.784.1110
www.tmcc.edu

2201 W. College Parkway
775.445.3000
www.wnc.edu

Charter Schools

Academy for Career Education

Grades: 9-12
2800 Vassar Street, Reno
775.324.3900
www.acehighschool.org

Bailey Charter Elementary School

Grades: K-6
210 Gentry Way, Reno
775.323.6767
www.baileycharter.org

Coral Academy of Science

Grades: K-12
1701 Valley Rd, Reno
775.322.0274
www.coralacademy.org

Mariposa Dual Language Academy

Grades: K-5
3875 Glen Street, Reno
775.826.4040
www.mariposaacademy.net

High Desert Montessori School

Grades: infant/toddler-8
2590 Orovada St, Reno
775.624.2800
www.hdmsreno.com

enCompass Academy Center

Grades: 9-12
1300 Foster Avenue
775.322.5566
www.rainshadowcchs.org

Sierra Nevada Academy

Grades: K-8
13880 Stead Boulevard, Reno
775.677.4500 x13
www.snacs.org

State Sponsored Charter Schools

Alpine Academy High School

Grades: 9-12
605 Boxington Way, Suite 112, Sparks
775.356.1166
www.alpineacademy.net

Nevada Connections Academy

(Distance Education)
Grades: K-12
5690 Riggins Court, Suite B, Reno
775.826.4200 x325
www.connectionsacademy.com

Doral Academy of Northern Nevada

Grades: K-8
3725 Butch Cassidy Drive
775.453.4329

Honors Academy of Literature

Grades: K-8
195 N Arlington Ave
775.737.4084

Mater Academy of Northern Nevada

Grades: K-8
775.470.8950

Nevada State High School

Grades: 11-12
7530 Longley Lane Suite 103
702.953.2600



Washoe County School District Highlights

New construction projects are underway to build and repair our schools due to voters who helped pass the ballot question (WC-1) in 2016. This provided the school district with enough capital to fund the repairs and building of new schools.

A new highschool will open at Wildcreek, the land has already been acquired and final designs are underway. This will act as the new existing Procter Hug High School zone and will help improve the overcrowding. It will open in August 2022.

Procter Hug High School will be converted into a Career & Technical Academy once all of the students are moved over to the new High School in Wild Creek. It is scheduled to reopen in August 2023.

2 million dollars worth of security upgrades have been added to all the schools in the district.

Information provided by the Washoe County School District (WCSD) - washoeschools.net

The District at a Glance

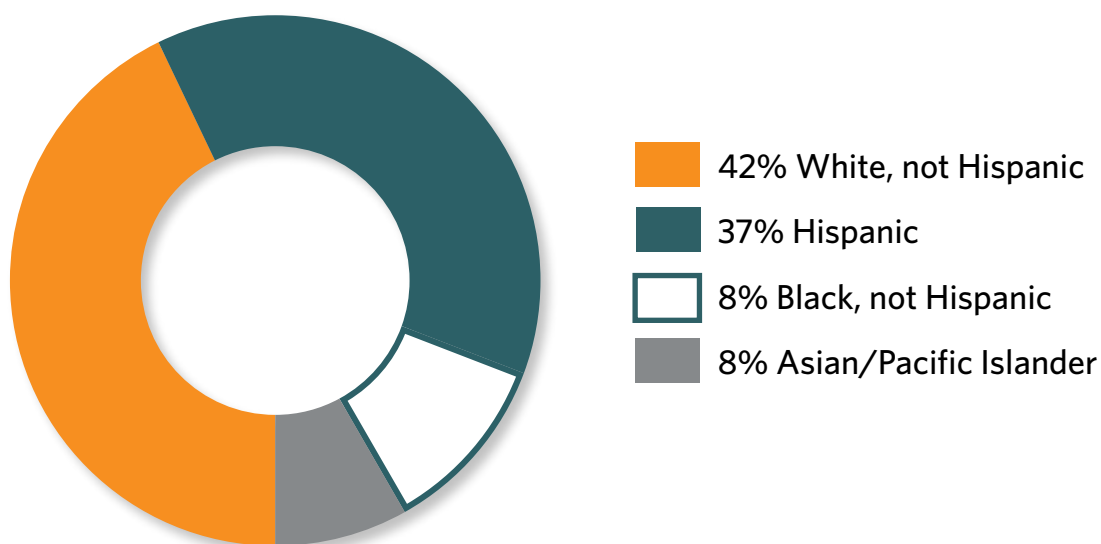

The Washoe County School District includes the Reno/Sparks metropolitan area, Incline Village, Gerlach, Empire and Wadsworth.

There are 63 elementary schools, a special education school, 14 middle schools and 13 comprehensive high schools. High school students may also apply to attend Truckee Meadows Community College High School (a magnet school), Washoe Innovations High School (an alternative school), or the Academy for Arts, Careers and Technology which offers a wide range of advanced level occupational classes.

Additionally, the District sponsors eight public charter schools.

(www.washoe.k12.nv.us)

Students Eligible for Free and Reduced Lunch

Our District: 37% **State:** 39% **Nation:** 47.5%

Teacher to Student Ratio

Our District: 19 **State:** 20

Source: www.GreatSchools.com

7 Out of 10 rating on GreatSchools.com!

(based on test scores)



Signature Schools

Academy of Arts, Careers & Technology
a Signature School with 7 career academies

Damonte Ranch Performing Arts Center
theater, dance, instrumental music, and choir

Galena STEM Academy
Project Lead the Way preengineering

Hug Health Sciences Academy
Sports Medicine and Health Information
Management

McQueen Global Studies Academy
foreign language, international politics/economics,
and diplomacy

**North Valleys Center for Agricultural Science
and Engineering**
Agricultural Engineering

Reed Enterprise Project
Biomedical studies, Culinary, and Civil &
Environmental Engineering

Reno Red House Project
Animation, Game Development, Graphic Design,
Video Production, Web Design Sparks

Information Technology Academy
Microsoft IT certifications

Spanish Springs C3 Media Academy
Publication, Graphic Design/Photography, Video
Production and Web Design

Wooster High School
a Signature School featuring International
Baccalaureate (IB) studies and the IB Career Crede

Washoe County School District's Signature Academies are an innovative approach to ensuring college and career readiness for all students. This initiative creates career- and industry-based programs at each comprehensive high school over the next four years. The Signature Academies will focus on specific programs, topics and distinguishing themes to prepare all students for the workforce of tomorrow.

source: www.washoe.k12.nv.us

School Locator Map

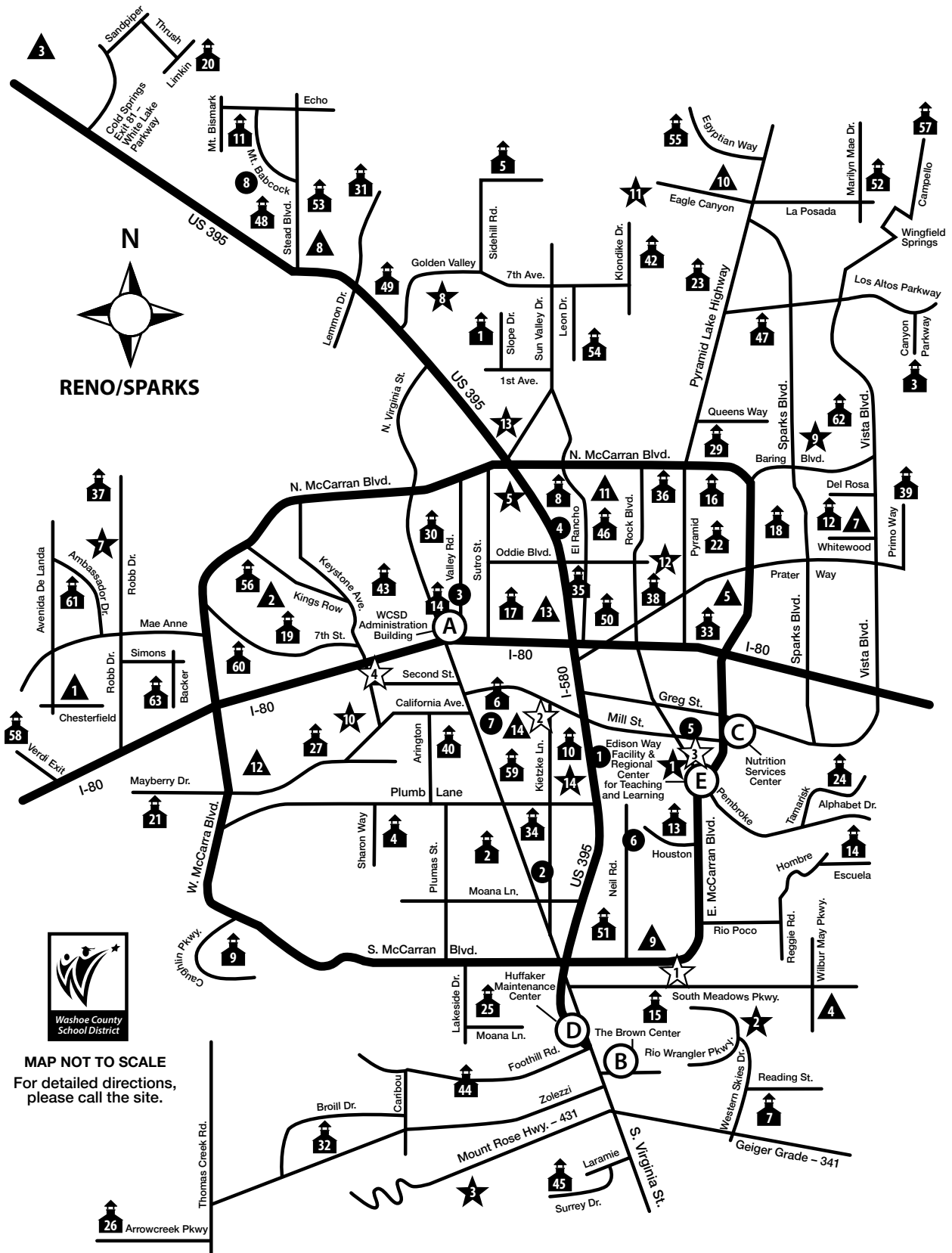

Washoe County Demographics

<i>Population</i>		
Population estimates, July 1, 2017, (V2017)	460,587	325,719,178
Population estimates, April 1, 2010, (V2017)	421,427	308,758,105
Population, percent change - April 1, 2010 (estimates base) to July 1, 2017, (V2017)	9.3%	5.5%
Population, Census, April 1, 2010	421,407	308,745,538
<i>Age and Sex</i>		
Persons under 5 years, percent, July 1, 2016, (V2016)	6.1%	6.1%
Persons under 18 years, percent, July 1, 2016, (V2016)	21.9%	22.6%
Persons 65 years and over, percent, July 1, 2016, (V2016)	15.9%	15.6%
Female persons, percent, July 1, 2016, (V2016)	49.7%	50.8%
<i>Race and Hispanic Origin</i>		
White alone, percent, July 1, 2017, (V2017)	84.8%	76.6%
Black or African American alone, percent, July 1, 2017, (V2017)	2.6%	13.4%
American Indian and Alaska Native alone, percent, July 1, 2017, (V2017)	2.2%	1.3%
Asian alone, percent, July 1, 2017, (V2017)	5.9%	5.8%
Native Hawaiian and Other Pacific Islander alone, percent, July 1, 2017, (V2017)	0.7%	0.2%
Two or More Races, percent, July 1, 2017, (V2017)	3.7%	2.7%
Hispanic or Latino, percent, July 1, 2017, (V2017)	24.6%	18.1%
White alone, not Hispanic or Latino, percent, July 1, 2017, (V2017)	62.8%	60.7%
<i>Population Characteristics</i>		
Veterans, 2012-2016	33,415	19,535,341
Foreign born persons, percent, 2012-2016	14.8%	13.2%
<i>Housing</i>		
Housing units, July 1, 2017, (V2017)	196,658	137,403,460
Owner-occupied housing unit rate, 2012-2016	56.8%	63.6%
Median value of owner-occupied housing units, 2012-2016	\$236,900	\$184,700
Median selected monthly owner costs -with a mortgage, 2012-2016	\$1,530	\$1,491
Median selected monthly owner costs -without a mortgage, 2012-2016	\$450	\$462
Median gross rent, 2012-2016	\$918	\$949
Building permits, 2017	4,554	1,281,977

Services



Quick Reference Guide

Contact information for various local utility and emergency services.

AT & T (Telephone & Internet)	800.288.2020	att.com
NV Energy (Gas/Electric)	775.834.4444	nvenergy.com
Waste Management	775.329.8822	wm.com
Washoe Co. Dept of Water Resources	775.954.4601	washoecounty.us/water
Truckee Meadows Water Authority	775.834.8080	tmh2o.com
Charter Spectrum	866.874.2389	charter.com
Reno Gazette Journal	775.788.6397	rgj.com
City of Reno Sewer	775.334.2095	reno.gov
City of Sparks Sewer	775.353.2360	cityofsparks.us
Department of Motor Vehicles	775.684.4368	dmvnm.com
United States Post Office	800.275.8777	usps.com
Washoe County Library System	775.327.8300	washoecountylibrary.us
Washoe County School District	775.348.0200	washoeschools.net
University of Nevada, Reno	775.784.1110	unr.edu
Truckee Meadows Community College	775.673.7111	tmcc.edu
Reno Police Dept (Non-Emergency)	775.334.2121	reno.gov/government/ departments/police
Sparks Police Dept (Non-Emergency)	775.353.2231	sparkspd.com
Nevada Highway Patrol	775.688.2500	nhp.nv.com
Reno Fire Dept (Non-Emergency)	775.334.2300	reno.gov/departments/ fire-department
Sparks Fire Dept (Non-Emergency)	775.353.2231	cityofsparks.us/departments/ fire-department
Road Conditions	511 or 877.687.6237	nvroads.com
Washoe Co. Animal Services	775.353.8900	washoecounty.us/animal
St. Mary's Hospital	775.770.3000	saintmarysreno.com
Renown Medical Center	775.982.4100	renown.org
Northern Nevada Medical Center	775.331.7000	nnmc.com
VA Hospital	775.786.7200	reno.va.gov
Washoe Co. Health Department	775.328.2400	washoecounty.us/health
Washoe Co. Poison Center	800.222.1222	washoecounty.us/poison
Better Business Bureau	775.322.0657	bbb.org/reno

Local Services

Utilities Etc.

DMV

Nevada Department of Motor Vehicles
www.dmvnv.com
775.684.4368

Electricity/Gas

NV Energy
775.834.4444

Garbage & Recycling

Waste Management
775.329.8822

Cable/Digital Television

Charter Communications
888.438.2427

Truckee Meadows Water Authority

(Reno/Sparks)
775.834.8080

Sewer Service

City of Reno - 775.334.2095
City of Sparks - 775.353.5555

Telephone

AT&T
800.288.2020

Voter Registration

Washoe County Registrar of Voters
775.328.3670
www.washoecounty.us/voters

Library

Washoe County Public Libraries
775.327.8300

Pet Licensing

Washoe County Animal Control
775.353.8900

United States Post Office

Reno Main Office - 2000 Vassar
Sparks Main Office - 750 4th Street

Newspapers

Reno Gazette Journal
775.788.6200
www.RGJ.com

Sparks Tribune

775.358.8061
www.sparkstrib.com

Reno News & Review

775.324.4440
www.newsreview.com/reno

Moving In

Apartment Guide
775.329.1442
www.apartmentguide.com

Reno-Sparks Association

of Realtors
775.823.8800
www.rsar.net

Medical Facilities

Northern Nevada Medical Center

2375 E. Prater Way, Sparks
775.331.7000
www.nnmc.com

Saint Mary's Regional Medical

Center
235 W. 6th, Reno
775.770.3000
www.saintmarysreno.com

Renown Medical Center

77 Pringle Way, Reno
775.982.4100
www.renown.org

Renown Rehabilitation Hospital

1495 Mill Street
775.982.3500

West Hills Hospital

1240 E. Ninth Street, Reno
800.242.0478
www.westhillshospital.net

Willow Springs Center

690 Edison Way, Reno
775.858.3303
www.willowspringscenter.com

Washoe County District Health

Department
775.328.2400
www.washoecounty.us/health

VA Sierra Nevada

1000 Locust Street, Reno
775.786.7200
www.reno.va.gov

CARE Chest of Sierra Nevada

775.829.2273
www.carechest.com

Centers for Disease Control & Prevention

800.232.4636 - English

Health Access Washoe County Clinic

1055 S. Wells Avenue
775.825.6702
www.chanevada.org

Medicaid Information

775.684.3600

National Cancer Institute

800.422.6237

United Blood Services

800.324.6454

University of Nevada School of Medicine

Family Medicine Center
206 N. Virginia Street
775.784.1223

US Dept of Health and Human Service

National Health Information
877.696.6775

Child Care & Youth Services

Childcare

A Child's World
775.322.4650

A + Learning Center
775.825.2522

Blue Kangaroo Learning Center
775.351.2583

Brookfield School
775.825.3003

**Child Garden - Preschool
& Kindergarten**
775.322.3471

Creative Kids Childcare Center
775.358.0110

Discoveries Pre-School
775.425.2273

Discoveries Pre-School
775.425.2273

El Cord Foundation Child Care Center
775.674.7515

Hippity Hop Learning Center
775.828.2928

Just Kidding Learning Center
775.425.2210

Kid R Kids Learning Center
775.853.5437

Milestones Early Childhood Learning
775.770.2269

McCarran Kindercare
800.709.8814

Little Bear Preschool-Childcare
775.358.4128

Montessori-Mountain View
775.852.6162

One World's Children's Academy
775.856.8339

**Sierra Summit Children's
Academy**
775.851.4769

Up And Away Learning Center
775.359.9640

The Goddard School
775.626.5678

Treasure Chest Learning Center
775.359.1122

Please check with the Department of Social Services for licensing compliance.
To find more daycare providers call the Children's Cabinet 775.856.6200/www.childrencabinet.org

Youth Services

**Washoe County Social Services
Child Care (licensing)**
775.337.4470

Children's Cabinet
775.856.6200

**Education Alliance
of Washoe County**
775.353.6950

Family Counseling Services
775.329.0623

**State of Nevada Division of Child &
Family Services Placement**
775.684.4400

State of Nevada Welfare Division
775.684.7200

**Big Brothers Big Sisters of
Northern Nevada**
775.352.3202



Senior Resources

Adult Daycare Program
775.328.2591

Alzheimer's Association of Northern Nevada
775.786.8061 or 800.272.3900

American Association of Retired Persons
775.328.2506

Citilift
775.348.0480

Elder Care Locator
800.677.1116

Lend-a-Hand Senior Services
775.322.8414

Senior Dimensions
800.650.6232

Meals on Wheels
775.328.2575

Social Security and Medicare Eligibility Information
800.772.1213

Senior Companion Program
775.358.2322

Washoe County Senior Services
775.328.2575

Nevada State Division for Aging Services
775.687.0800

Northern Nevada Center for Independent Living
775.353.3599

Nevada Department of Health & Human Services
877.267.2323 (Medicaid Information)

Veterans Administration Benefits/Info
800.827.1000

VA Medical Center
775.786.7200

Assisted Living

- Five Star Premier
775.829.1050
- Promenade on the River
775.786.8853

Foster Grandparent Program
775.686.5872

Retired Senior Volunteer Program
775.687.4680

City of Reno Senior Connect
775.657.4602
www.reno.gov

Senior Centers

Alf Sorensen Community Center
1400 Baring Blvd, Sparks
775.353.2385

City of Reno Northeast Community Center
1301 Valley Rd, Reno
775.334.2262

Reno-Sparks Indian Colony Senior Center
34 Reservation Rd, Reno
775.329.9929

Reno Senior Center
1155 E. 9th Street
775.328.2575

Sparks Senior Center
97 Richards Way
775.353.3110

The Continuum
3700 Grant Ave, Suite A
775.829.4700



Pet and Animal Services

Veterinarians

Animal Emergency Center
775.851.3600

All Creatures Veterinary Hospital
775.851.3151

High Sierra Equine
775.720.1034

A-Plus Animal Hospital
775.852.4300

VCA Feline Medical Center
775.829.0969

Pyramid Veterinary Hospital
775.356.8323

VCA Lakeside Animal Hospital
775.800.7384

Klaich Animal Hospital
775.826.1212

Desert Hills Animal Hospital
775.331.4700

Reno Animal Hospital
775.323.0100

Kennels, Boarding & Daycare

Honey Bears Country Kennels
800.713.7177

Canine Cottage
775.356.9222

Fantasia Pet Resort
775.322.1199

On Command Dogs
775.825.3647

Dognasium Day Care
775.851.7833

Equestrian Centers

Reno Tahoe Equestrian Centre
775.853.1385

**Franktown Meadows
Equestrian Centre**
775.849.1600

High Desert Equine Center
775.475.2250

Shelters & Rescue Orgs

Nevada Humane Society
775.856.2000
www.NevadaHumaneSociety.org

SPCA of Northern Nevada
775.324.7773
www.SPCAnevada.org

Washoe County Animal Services
2825 A. Longley Lane
775.353.8900
www.washoecounty.us/animal

**Canine Rehabilitation Center
and Sanctuary**
775.800.1906
www.CRCSgiveslife.org

Dog Parks

- Sparks Marina
- Rancho San Rafael
- Whitaker Park
- Virginia Lake Park
- Hidden Valley Regional Park



Local Churches

The Bridge Church

1330 Foster Drive
775.323.7141

Center for Spiritual Living

4685 Lakeside Drive
775.826.0566

The Church of Jesus

Christ Latter Day Saints
2000 Beaumont Parkway
775.747.6688

Community Bible Church

385 Gentry Way
775.358.8954

Congregation Temple Emanuel

1031 Manzanita Lane
775.825.5600

Covenant Presbyterian Church

6695 MaeAnne Avenue
775.746.8118

First United Methodist Church 209

W. 1st Street
775.322.4564

Grace Community Church

1220 Robb Drive
775.747.9000

The Little Flower Church

875 E. Plumb Lane
775.322.2255

Lord of Mercy Lutheran Church

3400 Pyramid Way
775.358.7863

Reno Assembly of God

524 Bell Street
775.323.7827

Reno Buddhist Center

820 Plumas Street
775.525.1182

Reno/Sparks Hispanic Seventh Day

Adventist Church
1555 Wedekind Rd.
775.501.0027

River View Adventist Church

7125 W 4th St, Reno, NV 89523
775.322.9642

The Rock Church

4950 Vista Blvd
775.355.7888

St. Rose of Lima Catholic Church

100 Bishop Manogue
775.851.1874

St. Thomas Aquinas Cathedral

310 W. Second Street
775.329.2571

Sparks Nazarene Church

2200 El Rancho Blvd
775.358.4066

Sparks Seventh Day

Adventist Church
2990 Rock Blvd.
775.331.4332

Summit Christian Church

7075 Pyramid Highway
775.424.5683

Temple Emanu-El

1031 Manzanita Lane,
775.825.5600

Temple Sinai

3405 Gulling Rd
775.747.5508

Trinity Episcopal Church

200 Island Ave
775.329.4279



Transportation

Reno Tahoe International is the only major airport in Reno/Sparks which has many destination points around the world.

Reno/Tahoe International Airport

2001 E. Plumb Lane
775.328.6400
www.renoairport.com

Carson City Airport

2600 E College Parkway
775.841.2255
www.flycarsoncity.com

South Lake Tahoe Airport

1901 Airport Rd
530.541.0484
www.laketahoeairport.com

Amtrak

Reno offers railroad service for passengers and freight.
280 N Center Steet
775.329.8638

Greyhound Bus Line

Greyhound Bus Lines operate throughout the country and have many services in and out of Reno.
155 Stevenson St
775.322.2970

Regional Transportation Commission

Citifare Public Bus Line provides local transportation throughout Reno year round.
775.348.7433
www.rtcwashoe.com

Taxi Service

Reno Sparks Cab Co. - 775.333.3333
Whittlesea Taxi - 775.322.2222
Yellow Cab Company - 775.355.5555

Things to Do





Special Events

Reno/Sparks is home to the Reno/Tahoe Open, Hot August Nights, Reno Rodeo, Reno Championship Air Races, Great Reno Balloon Races, The National Bowling Stadium, and Shakespeare at Lake Tahoe and the home of The Reno Aces AAA Baseball Team. Other events include Cinco de Mayo Celebration, The Great Italian Festival and Street Vibrations and the counter-cultural festival, Burning Man held in the Black Rock Desert 90 miles north.

Reno/Sparks/Tahoe is the cultural center of the Sierra's. The arts are alive with the area's own Philharmonic Orchestra, Chamber Orchestra and the annual UNR Jazz Festival. One of the area's most successful events is ARTown, which has grown in to one of the largest visual and performing festivals in the country because of the events that take place during the entire month of July.

Reno/Sparks/Tahoe's natural beauty and its distinctive four season climate combine to offer almost every type of recreational activity. The majestic Sierra Nevada mountains form the western boundary of the Truckee Meadows features Alpine and Nordic skiing at 18 major resorts. Fishing, sailing, swimming, hiking, biking, camping and horseback riding are all exceptional and less than half an hour away in the numerous mountains or desert lakes surrounding the Reno/Sparks/Tahoe area.

For event location and details, visit www.visitrenotahoe.com.



Golf Courses

Private

Arrowcreek Country Club

2905 Arrowcreek Pkwy
775.850.4653
golfarrowcreek.com

Hidden Valley Country Club

3575 E. Hidden Valley
775.857.4735
hvccreno.com

Montreux Golf & Country Club

16475 Bordeaux Drive
775.849.1090
montreuxgolf.com

The Private Club at Redhawk

6295 Wingfield Springs
775.626.6000
redhawkgolfandresort.com

Thunder Canyon

19 Lightning W Ranch Rd
775.882.0882
thundercanyon.com

Somersett Country Club

2019 Championship Trail
775.787.1800
Somersetgolfandcountryclub.com

Public

Lakeridge Golf Course

1218 Golf Club Drive
775.825.2200
lakeridgegolf.com

Rosewood Lakes

6800 Pembroke Drive.
775.857.2892
rosewoodlakes.com

Sierra Sage Golf Course

6355 Silver Lake Rd, Reno
775.972.1564
sierrasagegolf.org

Wolf Run Golf Club at Fieldcreek

1400 Wolf Run Rd, Reno
775.851.3301
wolfrungolfclub.com

Washoe County Golf Course

2601 Foley Way
775.828.6633
washoegolf.org

Wildcreek Golf Course

3500 Sullivan Lane
775.673.3100
wildcreekgolf.com



Winter Recreation

The Reno / Lake Tahoe region has a wide variety of top cross-country skiing areas, downhill ski resorts, and snow play areas. Sprinkled around the Lake Tahoe area, these winter sports areas are blessed with abundant snow, excellent accommodations, and easy access from Reno, Sacramento, and the Bay Area. In addition to downhill and cross-country skiing, winter sports opportunities include snowshoeing,

	<u>Top Elevation</u>	<u>Base Elevation</u>	<u>Vertical Drop</u>	<u>Chairlifts</u>	<u>Novice Runs</u>	<u>Intermed</u>	<u>Advanced</u>
Alpine Meadows (530) 583-4232	8637'	6835'	1802'	13	24	40	35
Boreal (530) 426-3666	7700'	7200'	500'	9	30	55	15
Diamond Peak (775) 832-1177	8540'	6700'	1840'	6	18	46	36
Donner Ski Ranch (530) 426-3635	7781'	7031'	750'	6	25	50	25
Homewood (530) 525-2992	8740'	6230'	2510'	8	15	50	35
Mt. Rose (775) 849-0704	9700'	8260'	1800'	6	20	30	50
Northstar-at-Tahoe 1800 go north	8610'	6330'	2280'	15	25	50	25
Soda Springs (530) 426-3901	7300'	6750'	550'	2	30	50	20
Squaw Valley USA (530) 452-4000	9050'	6200'	2850'	29	25	45	30
Sugar Bowl (530) 426-9000	8383'	6883'	1500'	13	17	45	38
Tahoe Donner (530) 587-9444	7350'	6750'	600'	4	40	60	



Parks and Recreation

Galena Creek Recreation Area

The center includes a weather station, exhibits, gift shop and book store. A half-mile paved nature trail is located just outside the Visitor Center along with access to the Jones-Whites Creek Loop Trail and the Mt. Rose Wilderness. The Recreation Area has individual picnic areas and one large group picnic area and a new trailhead.

Lazy 5 Regional Park

Park includes a 2,400 sq. ft. community center with outdoor patio and barbecue area, a water play park, two playgrounds, volleyball courts, horseshoe pits and two multi-use athletic fields.

Bowers Mansion Park

The Stately Bowers mansion is located in the center of the park and offers a rare glimpse into Nevadan life in the 1860's. The park also includes an outdoor swimming pool, playground, group and individual picnic areas.

Bartley Ranch Regional & Robert Z.

Hawkins Amphitheater

Consisting of 56 acres of scenic pasture, walking trails, a regulation size horse arena and warm-up area, the Western Heritage Interpretive Center and the Old Huffaker School.

Truckee River Walk

Features native Nevada wildlife relief's and unique fountains year-round. The River walk is a perfect place to take a leisurely stroll and take in the beauty that surrounds downtown Reno.

Sand Mountain

Sand Mountain is a dune over 100 meters high located about 2 hours from Reno. It is popular with camping and offroad vehicle enthusiasts.

Sparks Marina

77-acre lake with year round picnicking, fishing, jogging trails and children's playground. A family beach, volleyball courts and a dog park.

Rancho San Rafael

The Wilbur D. May Arboretum and Botanical Garden ~ one of the most beautiful and diverse gardens in Nevada. Twelve acres covered with groves of trees, wetland habitats, outdoor courtyards and secluded gardens.



Nevada State Parks

Camping, fishing, hiking, swimming, nature study, stargazing—not your thing? How about mountain biking, horseback riding, boating, water skiing, snowshoeing, ice-skating? Choose your favorite outdoor activity and Nevada State Parks will provide a place for it. Nevada’s 23 state parks, recreation areas and historic sites are stretched across terrains as diverse as alpine forests and bonedry deserts. Among them are natural lakes and man-made reservoirs, such as world-famous, 22 mile long Lake Tahoe or the much smaller Echo Canyon and its 35-acre reservoir. Other parks provide glimpses into the past. Valley of Fire is one of the state’s oldest, with 3,000-year-old petroglyphs carved in sandstone and

breathtaking views of the maroon-colored rock formations created during the age of the dinosaurs. Mormon Station in Genoa and the Old Las Vegas Mormon Fort feature replicas of 19th-century fortifications and visitor centers explaining regional history. Many campgrounds and RV facilities are open all year, depending on the weather - you can even stay in a yurt at Cave Lake State Park near Ely. Trailheads are well marked, and facilities at many parks include RV dump stations, showers and day use facilities for groups. For more information on Off-highway Vehicles (OHV) registration, go to Department of Motor Vehicles at dmv.nv.com.

- Beaver Dam State Park
- Berlin-Ichthyosaur State Park
- Big Bend of the Colorado State Recreation Area
- Cathedral Gorge State Park
- Cave Lake State Park
- Dayton State Park
- Echo Canyon State Park
- Elgin Schoolhouse State Historic Site
- Fort Churchill State Historic Site
- Fort Churchill State Historic Park
- Kershaw-Ryan State Park
- Lahontan State Recreation Area
- Lake Tahoe Nevada State Park
- Sand Harbor
- Spooner Backcountry
- Cave Rock
- Mormon Station State Historic Park
- Old Las Vegas Mormon Fort State Historic Park
- Rye Patch State Recreation Area
- South Fork State Recreation Area
- Spring Mountain Ranch State Park
- Spring Valley State Park
- Valley of Fire State Park
- Ward Charcoal Ovens State Historic Park
- Washoe Lake State Park
- Wild Horse State Recreation Park

Information courtesy of <http://parks.nv.gov>



Places To Eat

Fine Dining

Beaujolais Bistro
753 Riverside Drive
775.323.2227

Bistro 7
7111 S Virginia St B
775.851.9463

Bimini Steakhouse
2707 S Virginia St
866.821.9996

Bistro Napa @ the Atlantis
3800 S. Virginia St
775.825.4700

Bricks
1695 S. Virginia
775.786.2277

Cactus Creek
4702 N. Virginia St
775.334.5555

Charlie Palmers @ Grand Sierra
2500 E. Second St
775.789.2456

Ichiban's Japanese Steakhouse
206 N. Virginia
775.323.5550

Peavine Taphouse Eats and Beats
7665 Town Square Lane #101
775.276.6761

The Steakhouse @ The Nugget
1110 Nugget Avenue
775.356.3300

LuLou's Restaurant
1470 South Virginia, Reno
775.329.9979

Wild River Grille & River Room
17 S. Virginia Street
775.284.7455

Local Favorites

Brasserie Saint James
901 S Center St
775.348.8888

Buenos Grill
3892 Mayberry Drive
775.787.8226

Café De Thai
760 S Virginia St
775.829.8424

Campo Reno
50 N Sierra St
775.737.9555

Cheese Board & Wine Cellar
247 California Avenue
775.323.3115

Grateful Gardens
555 S Virginia St
775.324.2013

Great Basin Brewery
846 Victorian Ave
775.355.7711

Louis' Basque Corner
301 E. 4th Street
775.323.7203

Moxie's Spirits & Dining
6275 Sharlands Avenue
775.747.2665

Murrieta's
3060 Vista Blvd
775.356.1144

Old Granite Street Eatery
243 S. Sierra St
775.622.3222

Peg's Glorified Ham & Eggs
1495 E Prater Way
775.331.3388

Palais De Jade
960 West Moana Lane
775.827.5233

Pinocchio's
4820 Vista Boulevard
775.626.0101

Silver Peak on the River
135 N. Sierra
775.284.3300

Squeeze In
25 Foothill Rd
775.853.6090

ZoZo's (Pan Vino)
3446 Lakeside Drive
775.829.9449



Shopping

From the spectacular to the sublime, Reno/Sparks has the boutiques, retail stores, shopping malls, and outlet stores you need. Whether you're the most finicky bargain hunter or the biggest spender, whatever you're looking for, you'll find it in Reno/Sparks!

Cabela's

Cabela's stores are known as premier shopping and tourism destinations, drawing visitors from hundreds of miles to indulge in a unique shopping experience that celebrates nature and the lifestyle of the outdoor enthusiast.

Truckee River Arts District

Want to cater to your inner culture enthusiast? Located in close proximity to Reno's Truckee River Whitewater Park is the Truckee River Arts District. Both the CalAve and Riverwalk sections of the district feature unique shopping excursions to specialty shops, antique stores, boutiques, galleries and unique culinary attractions. This area is quickly becoming Reno's preeminent neighborhood retail, restaurant, entertainment and business district. No big box stores here in this newest, hippest section of Reno.

Mayberry Landing Shopping Center

A shopping oasis with a collection of 19 unique shops and restaurants. Mayberry Landing offers a variety of specialty stores. Including: gift shops, wine stores, restaurants, spas, hair salons, pet stores, dry cleaning, pilates, art classes and even music lessons!

Meadowood Mall

Meadowood Mall, a longtime favorite, is located right in the middle of Reno. Meadowood Mall in southwest Reno features hundreds of popular stores, including names like JCPenney, Macy's, Body Shop, Ann Taylor, Express and Gap. Clothing stores like American Eagle, Anchor Blue and PacSun are included alongside popular Victoria's Secret, Sephora and Bath & Body Works. The mall has jewelry stores, bookstores, shoe stores, electronics

stores, home furnishings stores, an extensive food court and even a salon.

The Legends at Sparks Marina

In Reno's sister city resides the Legends at Sparks Marina, which offers outlet shopping, dining and entertainment is located off I-80. The Legends is anchored by Scheels, the World's Largest All Sports Store. The complex also features an array of top brand outlet stores, many exclusive to the Northern Nevada region. Outlet retailers include: Adidas, Ann Taylor, Banana Republic, Bath & Body Works, BOSE, Carters, Converse, Easy Spirit, Gamestop, GNC, Grimaldi's Pizzeria, Gymboree, Guess, Harry & David, Kenneth Cole, Lane Bryant, Michael Kors, Nike, Nine West, Off Broadway Shoes, OshKosh, Vans, Volcom to name just a few.

The Summit

Located at the south end of Reno at Mt. Rose Highway, The Summit is an open-air lifestyle shopping center with more than 70 shops specialty retailers, salons and restaurants. Its many courtyards feature fountains, paths and fire pits to gather around on cool evenings. Retailers include: Abercrombie & Fitch, Aeropostale, Ann Taylor, Apple, Banana Republic, Bath & Body Works, Buckle, Cache, Charlotte Russe, Coach, Dillard's, Guess, Hollister, J. Crew, Jared "The Galleria of Jewelry", Lucky Brand Jeans, M-A-C Cosmetics, Sephora, Tilly's, Vans, Victoria's Secret, White House | Black Market, Williams-Sonoma, and more.

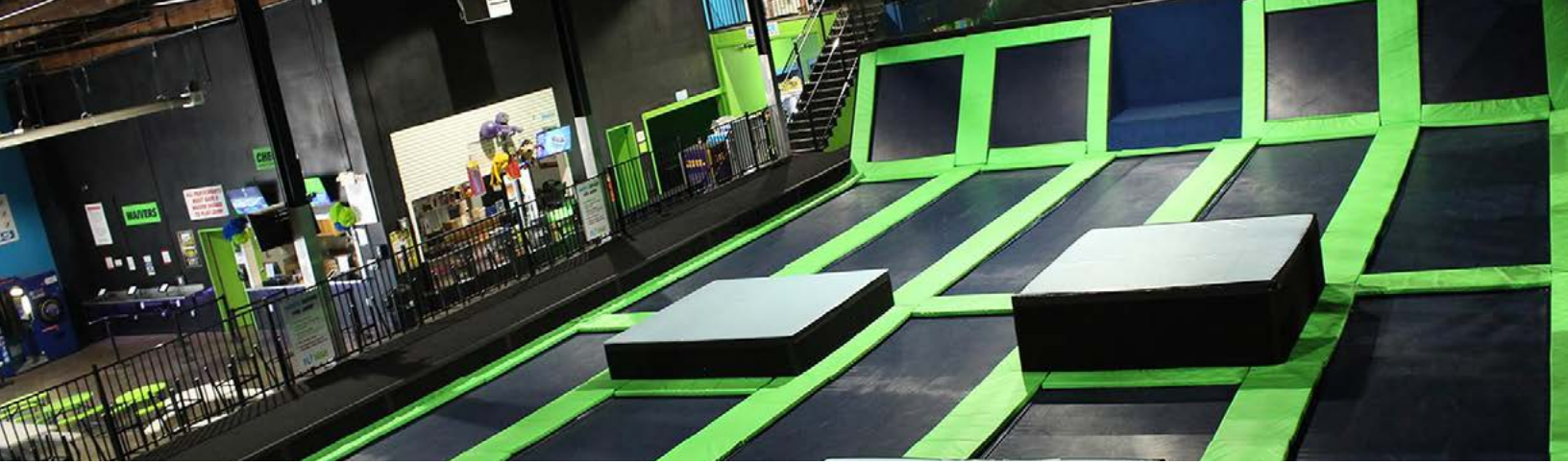

Fun Stuff For Kids

Animal Ark Zoo

775.970.3111, animalark.org

Atlantis Family Fun Center

775.825.4700

Base Camp @ Whitney Peak

775.398.5400, basecampreno.com

Boy Scouts - Nevada Area Council

775.787.1111

Cold Springs Park (skate park)

775.828.6642

Z Air Indoor Trampoline Park

775.853.1200, ezairsports.com

Fleischmann Planetarium

775.784.4812

Galaxy Imax Theater

775.313.0118

Girl Scouts of Nevada

775.322.0642

Grand Sierra Fun Quest Center

775.789.1127

Grand Sierra Aqua Driving Range

775.786.6699

Idlewild Pool & Playland

775.334.2267

Jump Man Jump

775.856.3226, www.jumpmanjump.com

Junior Achievement of Northern Nevada

775.323.8084

Magic Carpet Golf

775.853.8837, magiccarpetgolfreno.com

Need 2 Speed Indoor Go-Cart Track

775.851.7223, need2speed.com

Northwest Pool

775.334.2203

Rattlesnake Mountain Skate Park

@ Mira Loma Park

775.334.2270

Reno Indoor Paintball

775.342.5477, renoindoorpaintball.com

Rocksport Indoor Climbing Center

775.352.7673

Roller Kingdom

775.329.3472

Sierra Safari Zoo

775.677.1101

Truckee Meadows Boys & Girls Club

775.331.5437

Ultimate Rush Speed & Thrill Park

775.786.7005

Wild Island Family Adventure Park/Coconut Bowl

775.359.2927, wildisland.com

Wilbur D. May Center

775.785.5961, maycenter.com



ONE COMPANY. **ONE HEART.** ONE PHILOSOPHY.
NEARLY \$2.6 BILLION IN ANNUAL SALES.

Chase International is one of the nation's most successful independent real estate firms specializing in unique and distinctive properties in the Tahoe/Reno region. With more than 350 compassionate and determined REALTORS® in 12 locations, we are committed to our clients' success. We have more qualified luxury professionals and top lakefront specialists with the experience and connections to serve all your needs.

THE LEADER IN LUXURY REAL ESTATE



YOURRENOREALESTATEEXPERT.COM



CHASEINTERNATIONAL.COM



NICOLLE GUST

BROKER-SALESPERSON
775 338 9988
ngust@chaseinternational.com
NV BS 0145471

BRIAN SUNDEEN

REALTOR®
775 223 9696
bsundeen@chaseinternational.com
NV S 0193044

KATIE ROBINSON

REALTOR®
775 229 5763
krobinson@chaseinternational.com
NV S 0192395

Zephyr Cove | Glenbrook | Incline Village | South Lake Tahoe | Tahoe City | Truckee

Reno | Sparks | Carson Valley | Henderson | Roseville | Lake Almanor | London